



FOOTBALL

+ More



SHELOR MOTOR MILE

SHELOR.COM

2021 FOOTBALL SEASON TICKETS

More Info



Buy Tickets



Lane Stadium Fan Guide (A-Z)

⚠ For the 2020 Season, the following policies will be in effect. These override any policies listed in the A-Z guide below. All policies listed are subject to change.

- Beamer Way will close to all traffic from Washington Street to the Entrance of Lots 2 & 4 three and a half hours prior to kickoff.
- Public Parking will be available in Lot 5 ([see map](#)) for \$20.
- Tailgating is prohibited ([more info](#))
- RVs are not permitted on campus
- Gates open two (2) hours prior to kickoff.
- Clear Bag Policy is in effect ([more information](#))
- Visiting Team guests should enter through Gate 1. *Photo ID required.*
- Home Team guests should enter through Gate 5. *Photo ID required.*
- Everyone must wear a face covering at all times - unless eating or drinking.
- Chairback seats will be available for rent at Gate 1 for the East stands and near Gate 5 on the West. Rentals are \$10 per seat/ per game. Cash payments encouraged.
- ATMs are located on the East stands between Sections 9 & 11, and on the West stands at Section 2.

Below you will find a comprehensive description of the Virginia Tech Hokies' policies at Lane Stadium/Worsham Field. It is the team's wish that all patrons have a safe and enjoyable experience, and we believe that these policies will aid in accomplishing that endeavor.





FOOTBALL

+ More

- [Cameras](#)
- [Chairbacks](#)
- [Clear Bag Policy](#)
- [Code of Conduct / Hokies Respect](#)
- [Concessions](#)
- [Disability Information](#)
- [Elevators](#)
- [Family/Special Needs Restrooms](#)
- [First Aid](#)
- [Game Day Ticket Problems and Will Call](#)
- [Gates](#)
- [General Ticket Information](#)
- [Handicap Seating](#)
- [Handicap Parking](#)
- [Hokie Club Parking](#)
- [Hokies Respect](#)
- [Lost and Found](#)
- [Lost Persons](#)
- [Off Campus Parking](#)
- [Parking Lot Hours of Operation](#)
- [Postgame Traffic](#)
- [Prohibited & Permitted Items](#)
- [Public Parking](#)
- [Re-entry](#)
- [Request for Assistance](#)
- [Restrooms](#)
- [RV/Camper Parking](#)
- [Seating Chart](#)
- [Security Checks](#)
- [Smoking](#)
- [Souvenirs](#)
- [Tailgates, Corporate/Professional](#)
- [Tailgates, Regular](#)
- [Will Call](#)

Admission

All fans entering Lane Stadium/Worsham Field regardless of age must have a valid ticket to gain admission to the stadium. Once fans enter the stadium, they may not exit and re-enter.

Alcoholic Beverages

Alcoholic beverages **ARE STRICTLY PROHIBITED** within Lane Stadium/Worsham Field. Anyone caught possessing alcoholic beverages may be ejected from the stadium. **NO** refunds will be given in these cases.

ATMs

ATMs are located in the South End Zone on the main concourse, the East lower side between Sections 9 and 11, at Section 21 on the East upper side, and on the West side at Section 2.





Banners, signs and flags will not be permitted in Lane Stadium/Worsham Field.

Bus Parking

A very limited number of parking spaces are available for buses. Game day passes may be purchased in advance by calling [\(540\) 231-6731](tel:5402316731).

There are currently 10 bus spaces on Washington Street. A season pass is \$1,200.

In the event all spaces are not taken by the use of a season pass, the charge will be \$200 per game. NOTE: Game by game requests are to be made after August 1.

Bus Service/Off Campus Parking

Most of the parking lots listed below are within walking distance of Lane Stadium, while others have game day football shuttle service provided by Blacksburg Transit. If you have special needs due to a disability or injury, parking is available with transportation provided by BT Access shuttle service. For more information on game day parking lots and transportation, please visit our website at www.ridebt.org or call **(540) 961-1185**.

If you have any questions about assigned parking or tickets from Virginia Tech, please call **(800) 828-3244**.

Blacksburg Transit Fare on Virginia Tech Football Game Days

Blacksburg Transit offers service on all buses and shuttles on football game day(s). In addition to regular fixed-route service, Blacksburg Transit runs extra buses on regular routes to facilitate large crowds. BT also offers shuttle service from public parking at P2 (Blacksburg Middle School), located at 3109 Prices Fork Road, to Lane Stadium.

50¢ per rider	Beginning of service until three hours prior to kickoff
\$5 per rider*	Three hours prior to kickoff, until kickoff
Fare Free*	From kickoff until 3 hours after end of game
50¢ per rider	From 3 hours after the end of game until the end of service

** Exception: The game-day fare structure above is not applicable to passengers on The Explorer, Go Anywhere or Two Town Trolley. Monthly passes and Hokie passports are valid all day on game day.*

P2/Blacksburg Middle School: Shuttle service available beginning three hours prior to kickoff. Parking is \$12 per vehicle and located at 3109 Prices Fork Rd; parking fees support local school programs. See adjacent column for applicable bus fares (rate subject to change).

Gilbert Linkous Elementary: Route buses will serve existing bus stops on the Gilbert Linkous Elementary side of Toms Creek Road during Football games. Please wait at designated BT stops. Parking is \$8 per vehicle and located at 813 Toms Creek Rd.; parking fees support local school programs. See below for applicable bus fares (rate subject to change).

Harding Avenue Elementary: 22 minutes walking time to stadium. Parking is \$8 per vehicle and located at 429 Harding Ave. Fees support local school programs (rate subject to change).

Margaret Beeks Elementary: 17 minutes walking time to stadium. Parking is \$8 per vehicle and located at 709 Airport Rd. Fees support local school programs (rate subject to change).





FOOTBALL

+ More

Upper & Lower Municipal Lots. 15 minutes walking time to stadium. \$100 season pass – Call (540) 556-0746. Lots located at 300 S. Main Street. Proceeds support the Blacksburg Museum & Cultural Foundation.

For more information visit www.ridebt.org or call (540) 961-1185.

If someone wants to ride the Two Town Trolley or any of BT's Christiansburg services, regular fare applies

Cameras

No video or movie cameras will be permitted inside the stadium. Still cameras are permitted, however cameras with a detachable lens or tripods are not.

Chairbacks

Reserve a Hokie Stadium Seat by calling (800) 510-5614 or by logging on to HokieSeats.com. Stadium Chair backs are also available on game day for \$10.

Clear Bag Policy

To provide a safer environment for spectators and to expedite fan entry in to Lane Stadium, Virginia Tech Athletics has implemented a clear bag policy. The policy will allow for a better and quicker experience at gates and is also a public safety measure that is being successfully implemented at other large venues including fellow ACC venues.

Approved bags:

- Bags that are clear plastic, vinyl or PVC and do not exceed 12" x 6" x 12"
- One-gallon clear plastic freezer bag (Ziploc bag or similar)
- Small clutch bag approximately the size of a hand, with or without a handle or strap and no larger than 4.5" x 6.5"

Prohibited items include, but are not limited to:

- Purses larger than a clutch bag
- Coolers
- Briefcases
- Backpacks
- Fanny packs
- Cinch bags
- Luggage of any kind
- Computer bags
- Camera Bags
- Any bag larger than the permissible size

APPROVED BAGS

- CLEAR BAG**
Bag that is clear plastic, vinyl, or PVC and does not exceed 12" X 6" X 12"
- SMALL CLUTCH BAG**
Small clutch bag, approximately the size of a hand, with or without handle or strap. No larger than 4.5" X 6.5"
- PLASTIC STORAGE BAG**
One-gallon clear plastic freezer bag (Ziploc bag or similar)

PROHIBITED BAGS

- BACKPACK
- CAMERA CASE
- DIAPER BAG
- MESH BAG
- PURSE
- CHAIRBACK SEAT
- CLEAR BACKPACK
- TINTED PLASTIC BAG
- OVERSIZED TOTE BAG
- PRINTED PATTERN PLASTIC BAG
- BINOCULARS CASE
- FANNY PACK

While chairbacks are prohibited, seat cushions will be allowed inside Lane Stadium

Code of Conduct / Hokies Respect

Virginia Tech football should be an enjoyable experience for all fans. In order to promote athletic excellence and fan enjoyment we ask for your assistance in displaying a high degree of sportsmanship at all times.

Virginia Tech reserves the right to remove from the stadium those individuals whose conduct disrupts players, coaches, officials or





As we continue with that long-standing tradition, let us not forget "Hokies Respect" and our goal of creating a first-class environment to lend our support to the Hokies while maintaining a safe and fun environment for all Hokies and our visitors.

Concessions

Concession stands are located beneath all permanent stands and can be reached by exiting from any portal.

Disability Information

The Athletics Department provides special services for fans that have purchased parking passes in advance. Handicapped parking for the public is available for a \$20 fee on the day of the game in designated a parking lot ([see map](#)). A handicapped accessible shuttle is provided from this lot to the stadium.

Customers who require special assistance are urged to make all ticket arrangements well in advance by contacting the Athletics Ticket Office at [\(540\) 231-6731](tel:5402316731) or [\(1-800-VA TECH-4 \(800-828-3244\)\)](tel:1800VA TECH4).

Courtesy Shuttles will be stationed at gates inside the stadium and are available on an as-needed basis pre-game, throughout the game, and post game.

Special Needs Parking and Transportation

Virginia Tech and BT Access provide parking and transportation for individuals with disabilities or injuries that prevent them from using a regular route vehicle or walking to the stadium. Parking is located in the Special Needs Lot (\$20 parking fee, subject to change) in the E-Lot (Lot 20), on Stanger Street near the Perry Street intersection. Access to this lot requires a disabled parking placard or license plate. The BT Access shuttles provide service from the parking area to Gate No. 2 in the southwest corner of the stadium. Event staff will be at the gate to assist you if help is needed in getting to your seat. Shuttle service is available during and after the game to return to the Special Needs Lot from Gate No. 2.

To get to the Special Needs Parking Lot: Take Rte 460 to the Prices Fork — Downtown exit, go east towards Virginia Tech, turn right onto Stanger Street, right onto Perry Street and the parking lot will be on the right.

This service is available to individuals and their guests who park in the Special Needs Lot. Information is subject to change, to confirm please call [\(540\) 961-1185](tel:5409611185) or visit our website at www.btransit.org.

Elevators

Elevators are located in the South End and West Side. Access to elevators is limited to club and suite holders and working media. Credentials are required.

Family/Special Needs Restrooms

please see [Restrooms](#)

First Aid Rooms

First aid stations are in the West Side behind Section 20 and in the East Side behind Sections 1 and 31. The South End Zone station is located behind Section 202. There is a doctor on call at all times ([\(540-231-4915\)](tel:5402314915)). Fans can ask for assistance from the rescue squad members stationed at various portals around the stadium. Event staff members are available to help in locating first aid assistance.

Game Day Ticket Problems and Will Call





open 3 hours prior to game time and remains open through the end of the first half.

Visiting Team Will Call is located at Gate 2 in the South End Zone.

If available, game day tickets are on sale at the stadium at least four hours prior to the game.

If available, future game tickets are sold at the Lane Stadium ticket office until one hour prior to kickoff.

General Ticket Information

Every person must have a ticket, including infants.

Times and dates of games are subject to change.

The Athletics Ticket Office is not responsible for tickets that are lost, stolen or mailed to a second party.

No refunds or exchanges are permitted if the game is played.

If you are a person with a disability and desire special accommodations, you must notify the ticket office well in advance of the game. Due to demand for handicap accommodations, a copy of your current dated DMV paperwork or hangtag displaying your name & motor vehicle assigned number is required at the time of your order.

Game day ticket help line is [1-800-VA-TECH-4](tel:1-800-VA-TECH-4) or locally at [\(540\) 231-6731](tel:540-231-6731).

Gates

All gates open two hours prior to kickoff.

Public/Student Gates	Gate 1, 2, 3	South
	Gate 4, 5	West
	Gate 6	Northwest
	Gate 7	Northeast
	Gate 8	East
Home Team Player's Guest	Gate 4	West
Recruits	Gate 4	West
Visiting Team Player's Guest	Gate 2	South
VHSCA Coaches	Gate 2	South

Handicap Seating

see [Disability Accommodations](#)

Handicap Parking

see [Disability Accommodations](#)

Hokie Club Parking

Designated parking lots on campus are reserved for Hokie Club members on football game days ([see map](#)). Parking in these lots requires a valid parking pass that is mailed before the beginning of the season to qualifying Hokie Club members. Opportunity to purchase a season parking pass for home football games is a benefit of Hokie Club membership and all parking passes are





parking lots on game day. Tailgating must be confined to the area immediately behind your vehicle. Please do not block roadways or sidewalks. Parking lots will be monitored throughout the game. Additional parking information for football is available on the [Parking Services website](#)

For safety reasons as well as emergency access if necessary, the following are **NOT PERMITTED** in the parking lots:

- Throwing objects – This includes, but is not limited to, footballs and frisbees.
- Blocking the roadway – placing tables, chairs, cornhole boards or other items that may extend into the roadway beyond the bounds of the parking space provided is not permitted.
- Blocking the sidewalks – The sidewalks must remain open for pedestrian travel.
- Sound Systems / Noise amplification – This includes bands and DJ equipment.
- Cutting, removing, or destroying the boundary ropes or signs.
- Destroying landscaping or fencing.
- Underage drinking.

Improper use of parking passes:

All cars in the donor lots must keep their parking pass displayed at all times, or be subject to towing.

The owner of the pass is responsible for any violations of the policy due to someone using the pass. I.E. if you lend it out or sell it and there is a violation, you, as the owner of the pass, are responsible if any penalty occurs.

Because of the survey feedback, we will increase parking lot security and enforce the existing tailgating policy. In an effort to address the issues of parking space infringement and crowds spilling into the roadway, a line will be painted behind each parking spot in lots 1, 2, 3, 4 and 5. We request this line be the extension limit for your tailgate. Encroaching beyond the line will result in an infraction of the tailgating policies. This will ensure that we are keeping the roadway clear for emergency vehicles and that no one gets hit or run over.

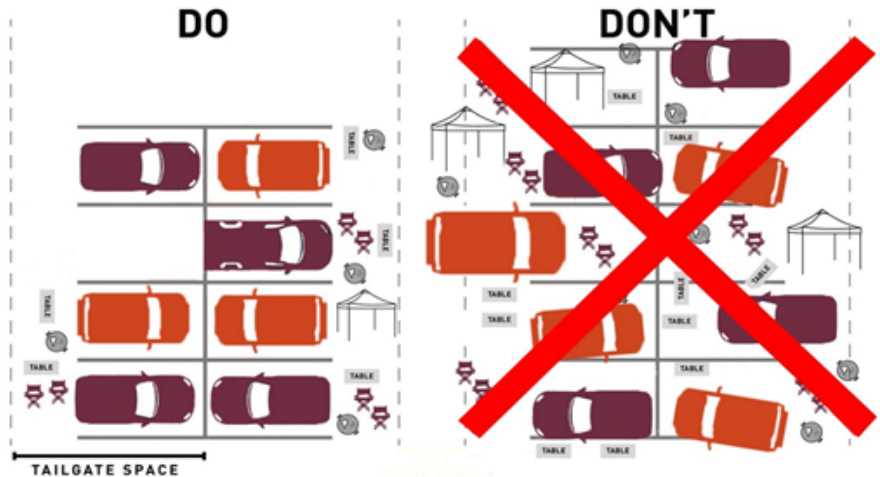

In the event that you are in violation of any of the tailgating rules, the following penalties will be enforced:

In the event that you are in violation of any of the tailgating rules, the following penalties will be enforced:

Tailgating Infraction Penalties

- 1st offense, you will receive an oral warning from security personnel. Additionally, an email will be sent to you regarding the violation.
- 2nd offense, you will receive another oral warning from security personnel. Additionally, you will receive a letter and a phone call from a Hokie Club representative regarding the violation.
- 3rd you will receive a written infraction notice from security personnel. Additionally, you will receive a letter from the Athletics Director and the Hokie Club Executive Director indicating that your parking eligibility has been revoked for the remainder of the 2018 season. Additionally, for the 2019 season, you will not be eligible to purchase a parking pass in Hokie Club donor lots. You would however, be eligible after one year to regain your parking privileges provided you remain in good standing with the Hokie Club





To report a lost person, contact the nearest event staff or police officer.

Parking Lots

See [Bus Parking](#), [RV/Camper Parking](#), [Handicap Parking](#), [Hokie Club Parking Lots](#), [Parking Map](#), [Public Parking](#)

Parking Lot Hours of Operation

<i>Saturday Games</i>		
	<i>Arrival</i>	<i>Departure</i>
Parking Lots (Donor/Public)	After 7 a.m. Saturday	Before 6 a.m. Sunday
RV's (Donor)	After 5 p.m. Friday	Before 5 p.m. Sunday
RV's (Public - Golf Course)	After 12 p.m. Friday	Before 5 p.m. Sunday
RV's (Public - Duck Pond)	After 5 p.m. Friday	Before 5 p.m. Sunday
<i>Non-Saturday Games</i>		
	<i>Arrival</i>	<i>Departure</i>
Parking Lots (Donor/Public)	After 4 p.m. game day	Before 6 a.m. following day
RV's (Donor)	After noon game day	Before 6 a.m. following day
RV's (Public - Golf Course)	After noon game day	Before 6 a.m. following day
RV's (Public - Duck Pond)	After 4 p.m. game day	Before 6 a.m. following day

Pregame & Postgame Traffic

Pregame Traffic Flow

Three-and-a-half (3.5) hours before kickoff, Beamer Way will be closed to all vehicle traffic from the entrance of Lots 2 & 4 to the intersection of Washington Street.



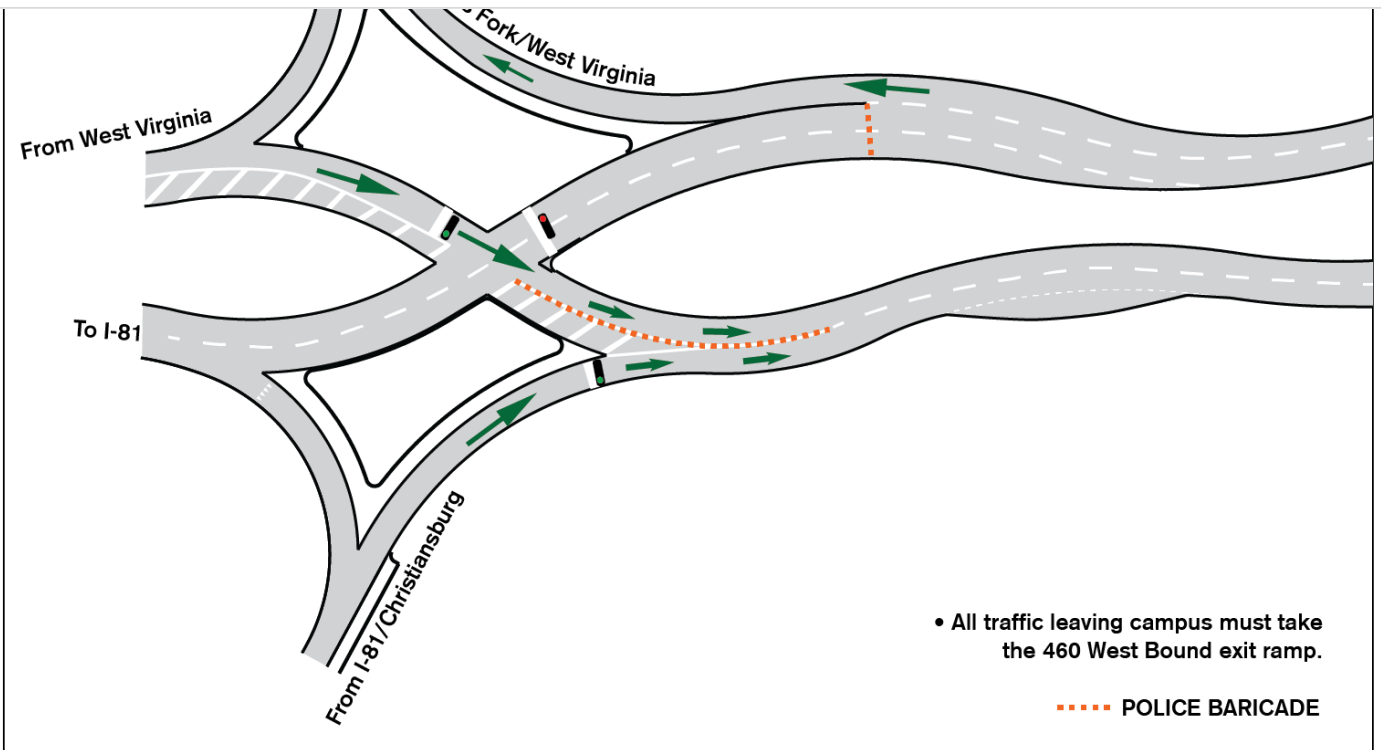

PREGAME

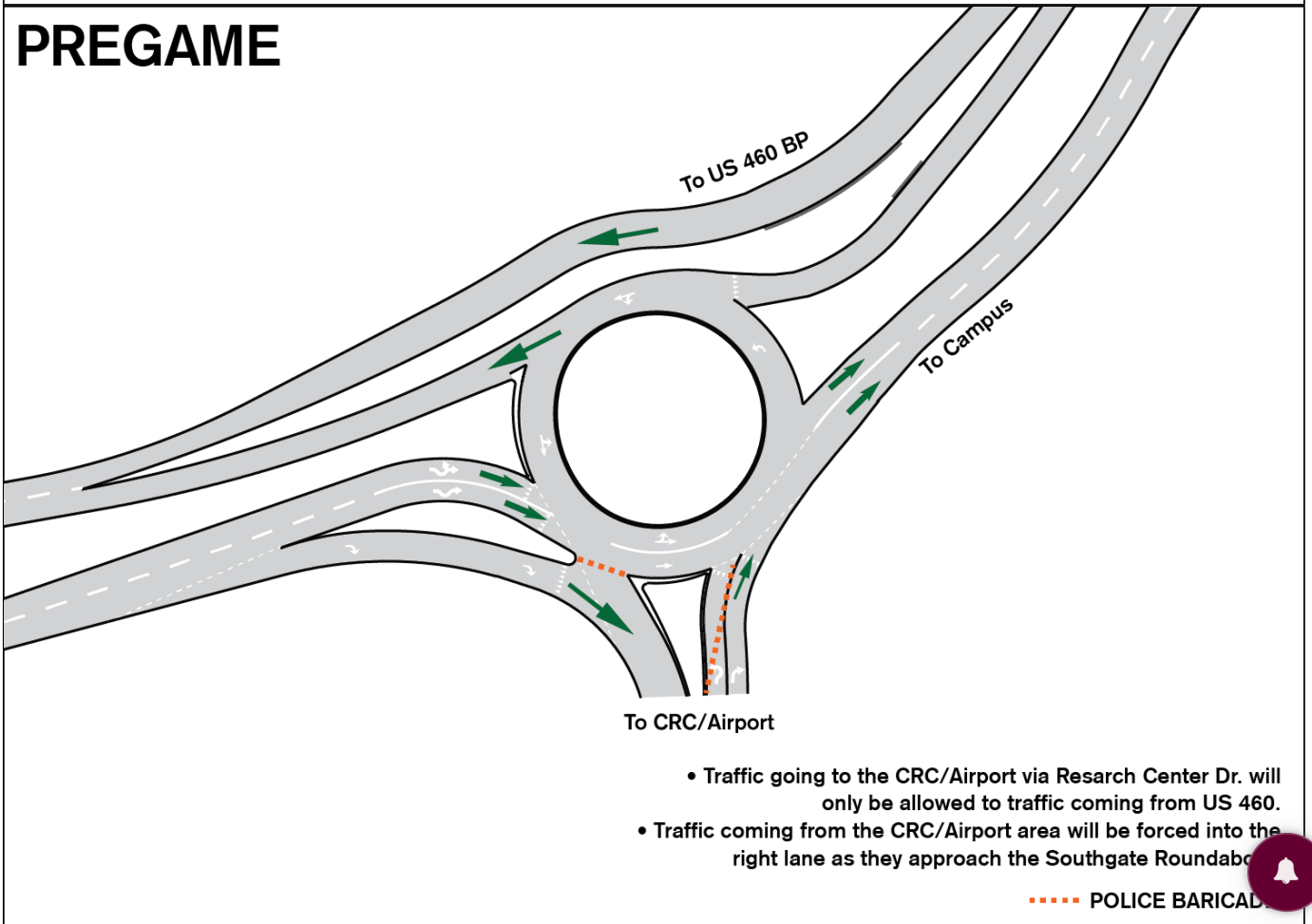

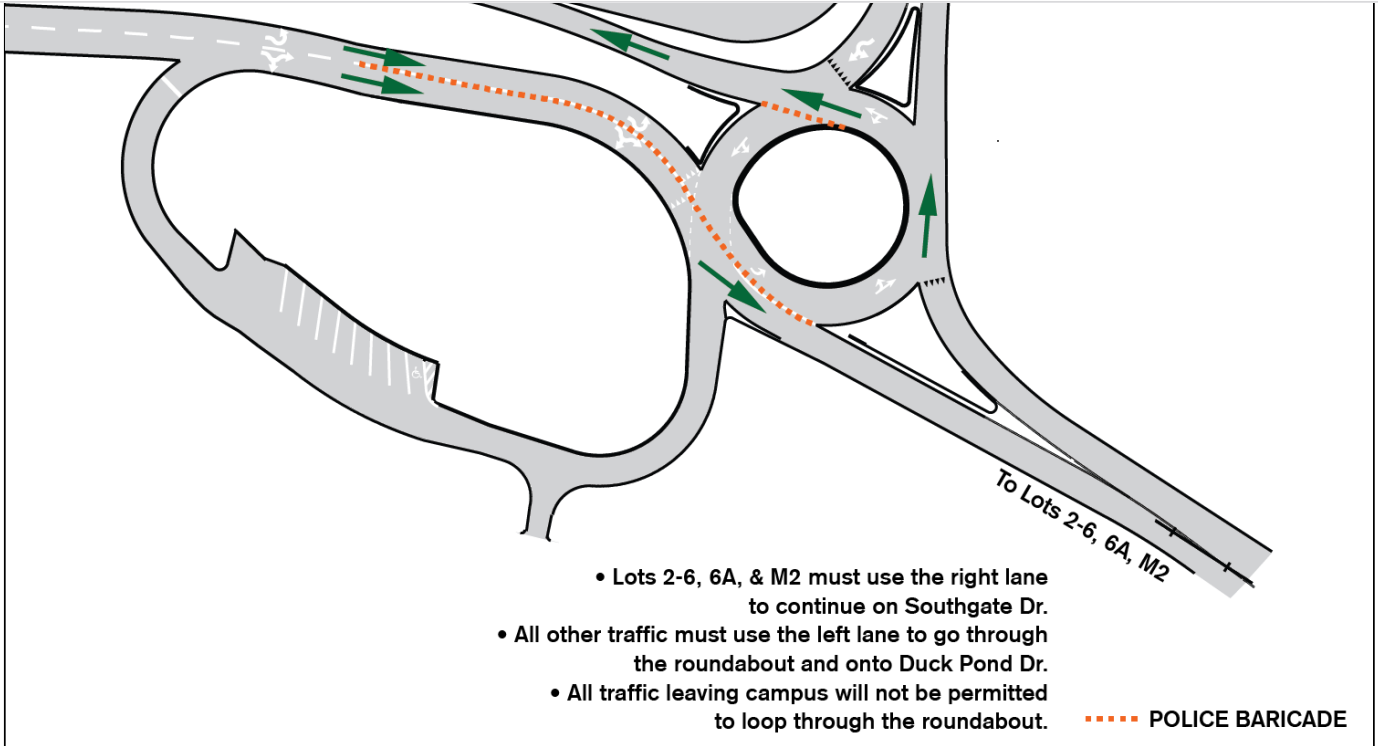

Postgame Traffic Flow

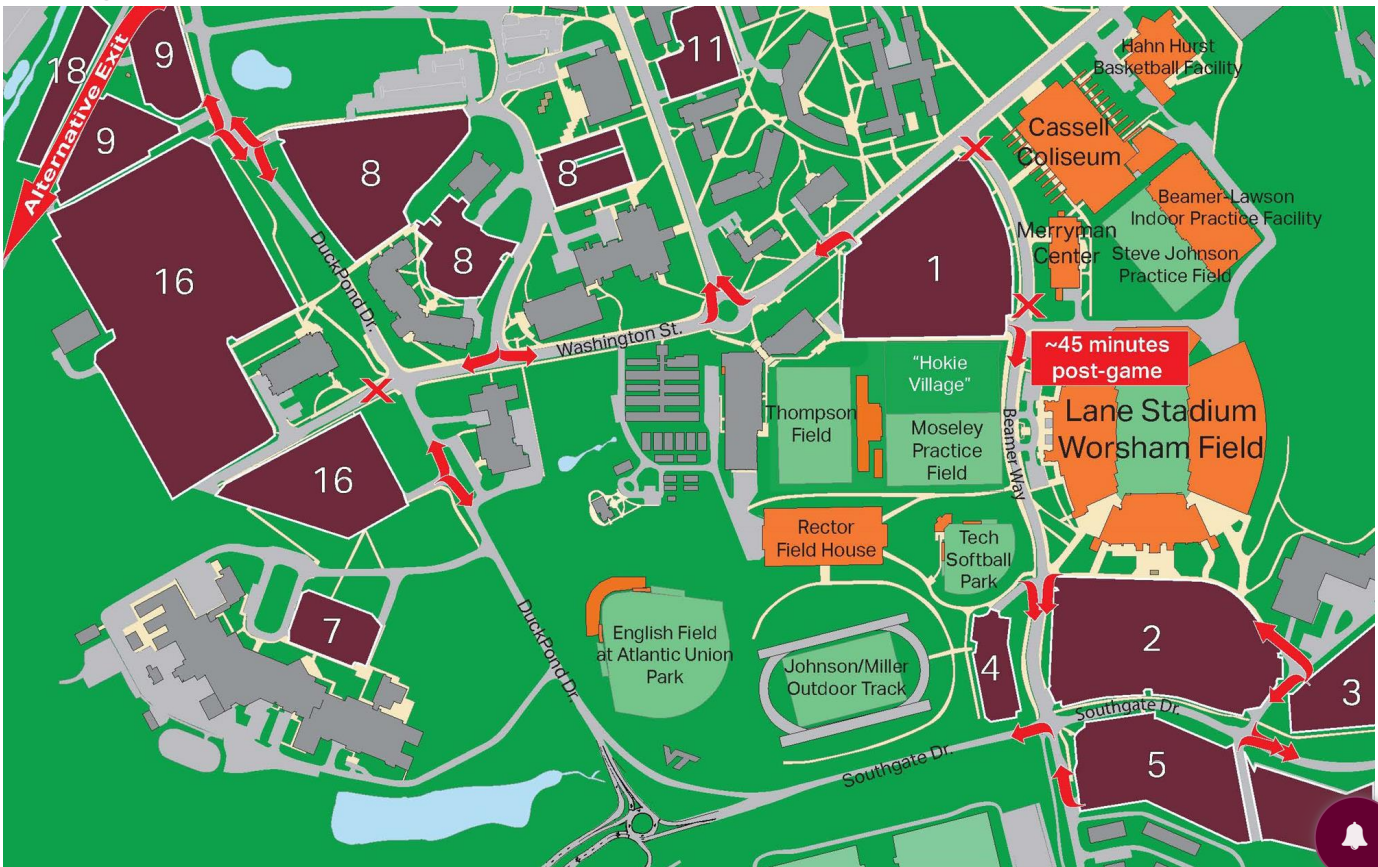

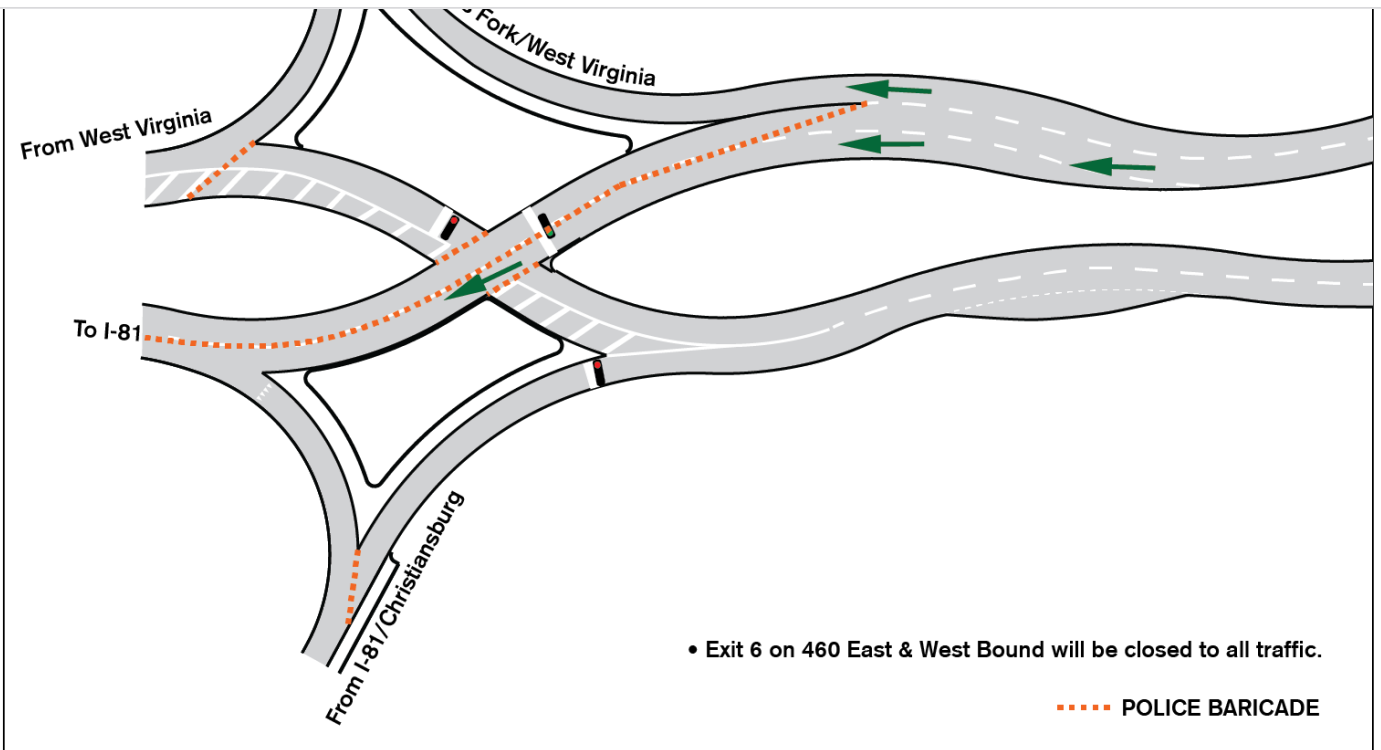

• Exit 6 on 460 East & West Bound will be closed to all traffic.

..... POLICE BARRICADE

POSTGAME

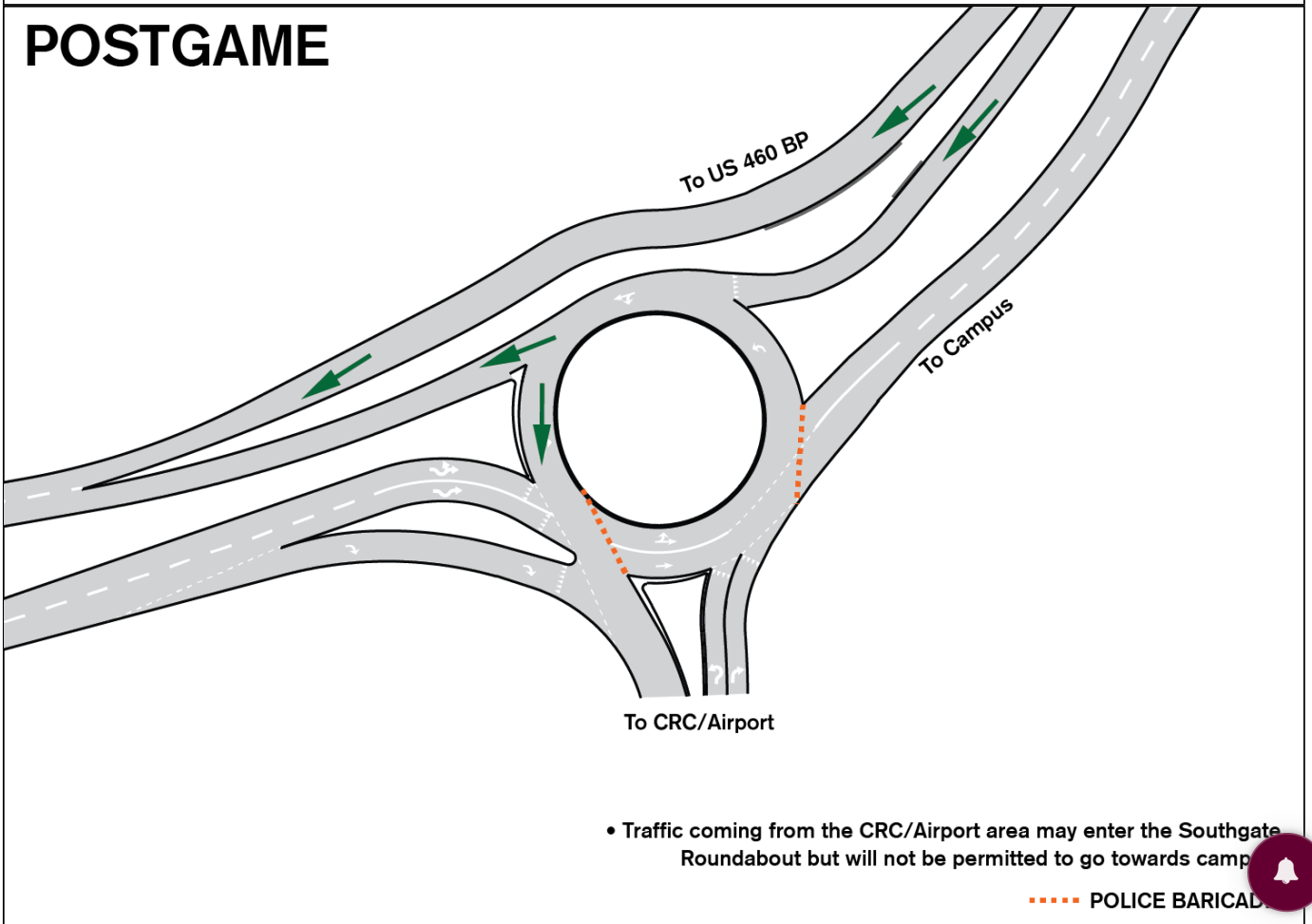

• Traffic coming from the CRC/Airport area may enter the Southgate Roundabout but will not be permitted to go towards campus.

..... POLICE BARRICADE



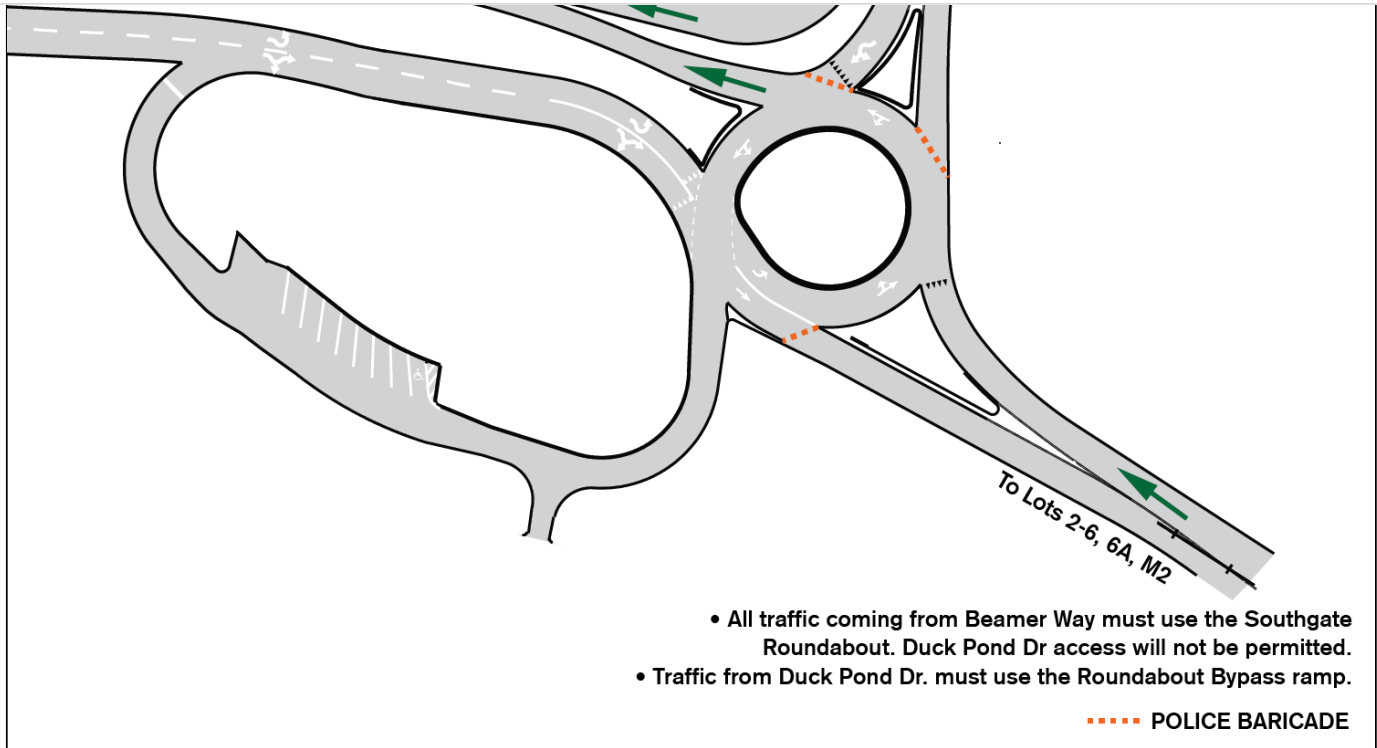

Prohibited & Permitted Items

All persons entering the stadium are subject to search. To protect the safety of our fans, players, officials and staff, the following items are prohibited.

PROHIBITED ITEMS

- Cameras with detachable lens
- Coolers/Containers (unless containing medical supplies)
- Diaper bags
- Fireworks / Explosive / Weapons
- Folding chairs
- Illegal drugs
- Large bags or backpacks
- Laser pointers
- Noisemakers (horns, whistles, cow bells, turkey calls, etc.)
- Outside food or beverage
- Pets (except service animals)
- Recording (audio or video) equipment
- Selfie sticks
- Signs, flags, banners
- Selfie sticks
- Smoking (including e-cigarettes)
- Strollers or umbrellas
- Unmanned aircraft (drones)

PERMITTED ITEMS

The following items are permitted inside the venue:





(See also, [Clear Bag Policy](#))

Public Parking

Public Parking is available on game day for \$20 in designated parking lots on campus ([see map](#)).

Satellite parking is available at P2 (3109 Price Fork Road). Blacksburg Transit provides a shuttle service ([more information](#)) from the Satellite Parking Lots to the stadium.

Re-entry

There is **NO** re-entry.

Request for Assistance

All requests for assistance and reports of discourtesy should be directed to stadium ushers. Personnel are positioned at each ramp throughout the stadium for convenience.

If issues with unruly fans or disruptive behavior occur, you can access the "Fan Assistance Hotline." Text ([540](#)) [739-0089](#).

Restrooms

Restrooms for men and women are located beneath all permanent stands and can be reached by exiting any portal.

Family/Special Needs restrooms are located in the following locations: Behind Section 1 in the East Stands and behind Sections 205 and 509 in the South End Zone as well as behind Sections 2 and 18 in the West Stands. All restrooms are equipped with diaper changing stations.

RV/Camper Parking

Hokie Club members who have purchased parking passes for RV's are located either in Lot 3 or 16. In order to park in either of these lots a season parking pass must have been purchased in advance. ([see map](#))

Public RV parking is available at the Virginia Tech/Montgomery Executive Airport, University Golf Course, and Duck Pond Drive.

The Virginia Tech/Montgomery Executive Airport spaces are purchased in advance for the season.

The University Golf Course and Duck Pond Drive accessible via Prices Fork Road, provides individual game parking. The cost is \$75 per game, first-come first-serve.

Seating Chart

A seating chart of Lane Stadium/Worsham Field can be found [here](#).

Security Checks

All persons entering the stadium will be subject to a visual search by stadium personnel prior to entering the gates.

Smoking

Virginia Tech is committed to providing a smoke-free environment in all facilities, both indoor and outdoor.





FOOTBALL

[+ More](#)

Kamp 10 and just inside the entrance of Gate 1, in the South End Zone.

Tailgates, Corporate/Professional

Corporate/professional tailgates are not allowed and no corporate signage is permitted at any time unless prior written approval by the Department of Athletics and Virginia Tech Sports Properties has been obtained.

Tailgates, Regular

see [Hokie Club Parking](#).

Will Call

please see [Game Day Ticket Problems and Will Call](#)





FOOTBALL

+ More

